

# Technical data sheet



## Product features

### Cooling counter GN 1/1 2x door

<b>Model</b>	<b>SAP Code</b>	00003805
--------------	-----------------	----------

- Material: Stainless steel
- GN / EN size in device: GN 1/1
- Number of GN / EN: 2
- Number of doors: 2
- Control type: Digital
- Minimum device temperature [°C]: -2
- Maximum device temperature [°C]: 8
- Insulation thickness [mm]: 60
- Unit: Right

<b>SAP Code</b>	00003805	<b>Energy class</b>	C
<b>Net Width [mm]</b>	1342	<b>Number of doors</b>	2
<b>Net Depth [mm]</b>	700	<b>Number of GN / EN</b>	2
<b>Net Height [mm]</b>	850	<b>GN / EN size in device</b>	GN 1/1
<b>Net Weight [kg]</b>	92.00	<b>Minimum device temperature [°C]</b>	-2
<b>Power electric [kW]</b>	0.247	<b>Maximum device temperature [°C]</b>	8
<b>Loading</b>	230 V / 1N - 50 Hz	<b>Refrigerant</b>	R290

# Technical data sheet



Technical drawing

## Cooling counter GN 1/1 2x door

Model

SAP Code

00003805

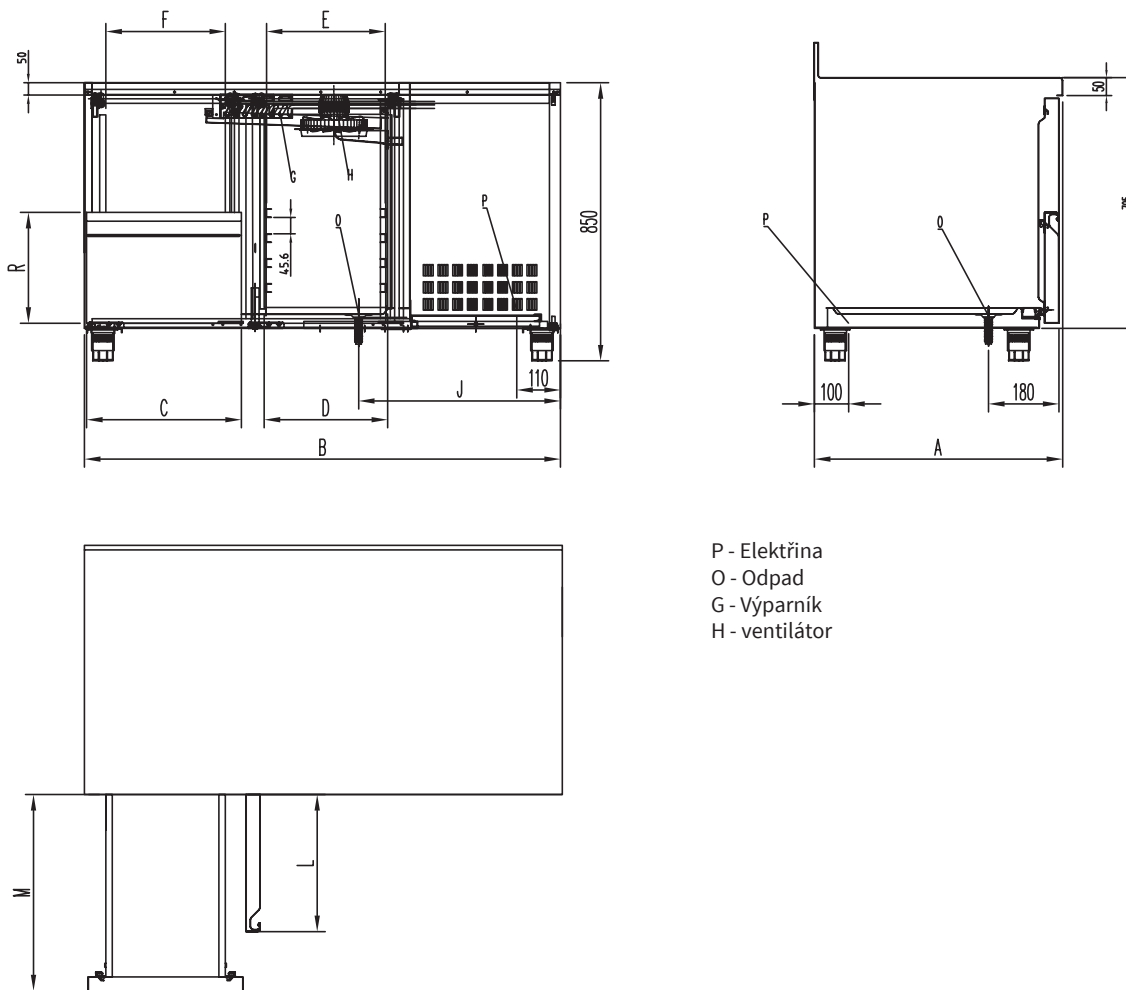

P - Elektrina  
 O - Odpad  
 G - Výparník  
 H - ventilátor

Model	A	B	C	D	E	F	J	L	M	R
RT 2D	700	1342	435	335	325	336	590	385	597	311
RT 3D	700	1792	435	335	325	336	590	385	598	311

# Technical data sheet



## Product benefits

### Cooling counter GN 1/1 2x door

Model

SAP Code

00003805

1

#### Insulation 50 mm

minimal heat loss

- saving electricity
- less wear and tear on the compressor due to less frequent switching

2

#### Socket block

1/2+1/2 drawers can be placed instead of doors

- more efficient food storage and less heat leakage

3

#### Boiled sink

possibility to install a hygienic sink above the unit

- making the working environment more efficient, ensuring hygiene regulations

# Technical data sheet



## Technical parameters

### Cooling counter GN 1/1 2x door

**Model**

**SAP Code**

00003805

**1. SAP Code:**

00003805

**2. Net Width [mm]:**

1342

**3. Net Depth [mm]:**

700

**4. Net Height [mm]:**

850

**5. Net Weight [kg]:**

92.00

**6. Gross Width [mm]:**

1420

**7. Gross depth [mm]:**

820

**8. Gross Height [mm]:**

1085

**9. Gross Weight [kg]:**

105.00

**10. Device type:**

Electric unit

**11. Power electric [kW]:**

0.247

**12. Loading:**

230 V / 1N - 50 Hz

**13. Energy class:**

C

**14. Refrigerant:**

R290

**15. Cooling type:**

Dinamic

**16. Material:**

Stainless steel

**17. Device properties 2:**

Cooling

**18. GN / EN size in device:**

GN 1/1

**19. Number of GN / EN:**

2

**20. Adjustable feet:**

Yes

**21. Insulation thickness [mm]:**

60

**22. Number of doors:**

2

**23. Unit:**

Right

**24. Control type:**

Digital

**25. HACCP:**

Yes

**26. Minimum device temperature [°C]:**

-2

**27. Maximum device temperature [°C]:**

8

**28. Gross Volume [m3]:**

1.263

# Technical data sheet



Technical parameters

Cooling counter GN 1/1 2x door

Model

SAP Code

00003805

## 29. Net Volume [m3]:

0.798